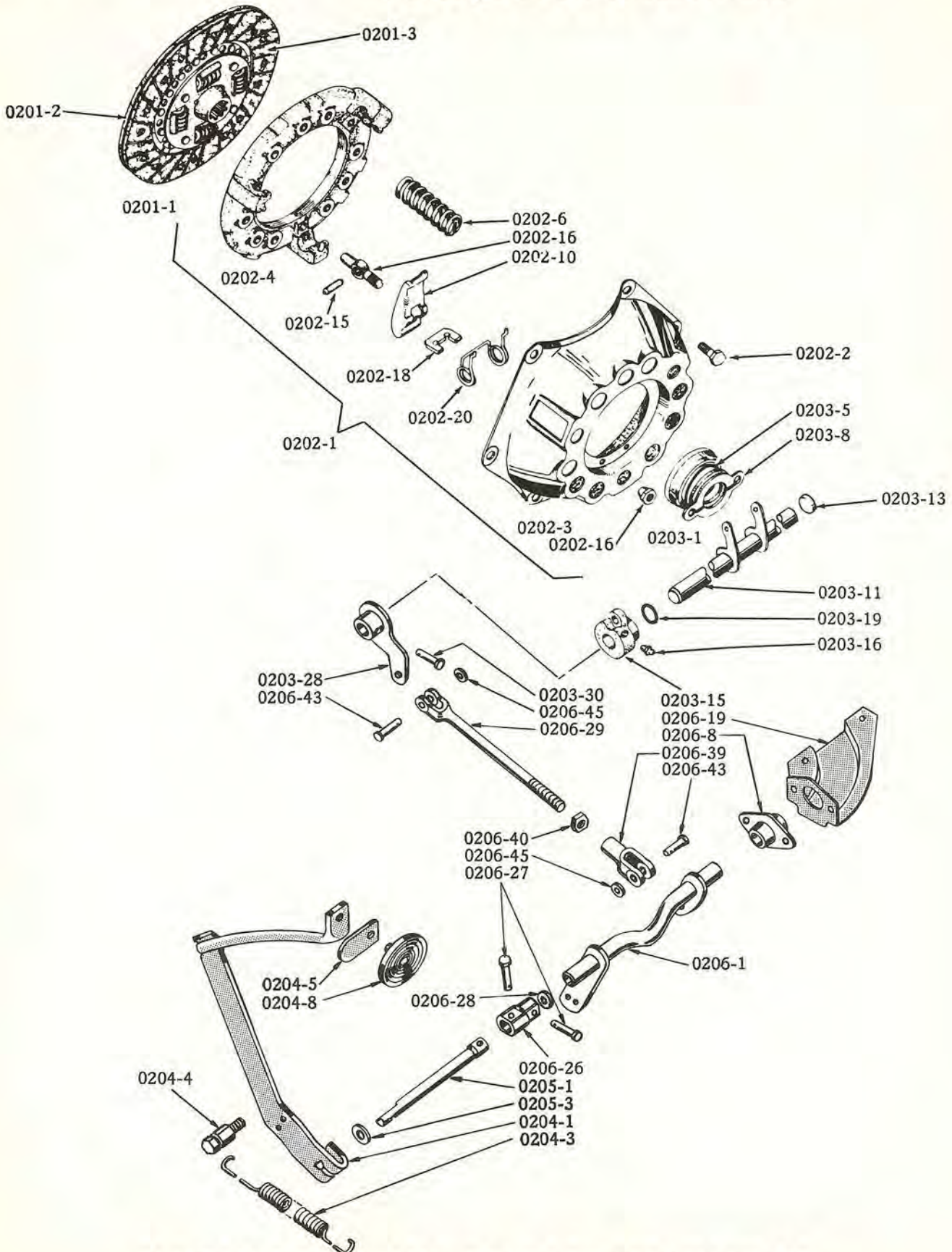

Plate 02-2

CLUTCH, PEDAL AND TORQUE CONVERTER



CLUTCH PEDAL AND RELEASE MECHANISM
 (Used with Standard and Overdrive Transmission) Models 14G, 4H

CLUTCH, PEDAL AND RELEASE MECHANISM

(Used With Standard And Overdrive Transmission)

0203

ILLUST. NUMBER	PART NUMBER	CHANGE	DESCRIPTION	MODELS	PER CAR
0201- CLUTCH DRIVEN PLATE WITH FACINGS (Plates 02-1,2)					
ST.-FOR CARS WITH STANDARD TRANSMISSION WITH OD.-FOR CARS WITH OVERDRIVE TRANSMISSION					
0201-1	519049		PLATE W/FACINGS, DRIVEN (ST.)	10G	1
0201-1	531687		PLATE W/FACINGS, DRIVEN (ST.)	12G, 14G	1
0201-1	519048		PLATE W/FACINGS, DRIVEN (WITH OD)	10G	1
0201-1	531688		PLATE W/FACINGS, DRIVEN (WITH OD)	12G, 14G	1
0201-1	522974		PLATE W/FACINGS, DRIVEN	H	1
0201-1	531689		PLATE W/FACINGS, DRIVEN	3H, 4H	1
0201-2, 3	513444		FACING, DRIVEN PLATE.	10G, 12G, 14G	2
	510821		RIVET 9/64"X5/32".	10G, 12G, 14G	16
0201-2, 3	513441		FACING, DRIVEN PLATE.	H, 3H, 4H	2
	662296		RIVET 9/64"X7/32".	H, 3H, 4H	32
0202- CLUTCH COVER AND PRESSURE PLATE (Plates 02-1,2)					
0202-1	521128		COVER W/PRESSURE PLATE.	10G, 12G, 14G	1
0202-1	531576		COVER W/PRESSURE PLATE.	H, 3H, 4H	1
0202-2	181280		SCREW, TO FLYWHEEL 5/16"-18X7/8"	10G, 12G, 14G, H, 3H, 4H	6
	380-05		WASHER, LOCK 5/16".	10G, 12G, 14G, H, 3H, 4H	6
0202-3	----		COVER, CLUTCH - NOT FURNISHED SEPARATELY - ORDER COVER W/PRESSURE PLATE	10G, 12G, 14G, H, 3H, 4H	1
0202-4	197129		PLATE, CLUTCH PRESSURE.	10G, 12G, 14G	1
0202-4	198867		PLATE, CLUTCH PRESSURE.	H, 3H, 4H	1
0202-6	197467		SPRING, CLUTCH PRESSURE PLATE (7 1/2 COILS) (PAINTED ORANGE)	10G, 12G, 14G	3
0202-6	521129		SPRING, CLUTCH PRESSURE PLATE (7 1/2 COILS) (PAINTED RED)	10G, 12G, 14G	3
0202-6	531577		SPRING, CLUTCH PRESSURE PLATE (7 3/4 COILS) (PAINTED LAVENDER) REPLACE IN SETS OF 9.	H, 3H, 4H	9
0202-10	197133		LEVER, CLUTCH TOGGLE.	10G, 12G, 14G	3
0202-15	197136		PIN, DOWEL, TO EYE BOLT 5/16"X59/64"	10G, 12G, 14G	3
0202-10	182697		LEVER, CLUTCH TOGGLE.	H, 3H, 4H	3
0202-15	182700		PIN, DOWEL, TO EYE BOLT 5/16"X1 5/32".	H, 3H, 4H	3
0202-16	517180		EYE BOLT AND NUT, CLUTCH TOGGLE LEVER ADJUSTING 3/8"-24X1 29/32" (SPECIAL NUT).	10G, 12G, 14G, H, 3H, 4H	3
0202-18	197135		STRUT, CLUTCH TOGGLE LEVER.	10G, 12G, 14G	3
0202-18	182701		STRUT, CLUTCH TOGGLE LEVER.	H, 3H, 4H	3
0202-20	197138		SPRING, CLUTCH TOGGLE LEVER ANTI-RATTLE	10G, 12G, 14G	3
0202-20	182698		SPRING, CLUTCH TOGGLE LEVER ANTI-RATTLE	H, 3H, 4H	3
0203- CLUTCH RELEASE BEARING, SHAFT AND LEVERS (Plates 02-1,2)					
0203-1	198118		BEARING AND COLLAR, RELEASE } INCLUDE WEAR PLATE.	10G, 12G, 14G	1
0203-1	513143		BEARING AND COLLAR, RELEASE } AND SPRING	H, 3H, 4H	1
0203-5	196087		SPRING, RELEASE BEARING COLLAR (INCL. IN 198118).	10G, 12G, 14G	1
0203-5	510171		SPRING, RELEASE BEARING COLLAR (INCL. IN 513143).	H, 3H, 4H	1
0203-8	199279		PLATE, RELEASE BEARING COLLAR WEAR (INCL. IN 198118).	10G, 12G, 14G	1
0203-8	199150		PLATE, RELEASE BEARING COLLAR WEAR (INCL. IN 513143).	H, 3H, 4H	1
0203-11	524950		SHAFT AND LEVERS, RELEASE - LHC	10G, 12G	1
0203-11	532031		SHAFT AND LEVERS, RELEASE - LHC	14G	1
	520844		SHAFT AND LEVERS, RELEASE - RHC	10G, 12G, 14G	1
0203-11	529216		SHAFT AND LEVERS, RELEASE - LHC	H, 3H	1
0203-11	531997		SHAFT AND LEVERS, RELEASE - LHC	4H	1
	530387		SHAFT AND LEVERS, RELEASE - RHC	H, 3H, 4H	1
0203-13	524848		PLUG, CUPPED 45/64" O.D.-LHC } PRESSED IN CLUTCH HOUSING	10G, 12G, 14G	1
0203-13	524849		PLUG, CUPPED 53/64" O.D.-LHC }	H, 3H, 4H	1

CLUTCH, PEDAL AND RELEASE MECHANISM

(Used With Standard And Overdrive Transmission)

0203

ILLUST. NUMBER	PART NUMBER	CHANGE <input checked="" type="checkbox"/>	DESCRIPTION	MODELS	PER CAR
0203- CLUTCH RELEASE BEARING, SHAFT AND LEVERS-Cont'd.					
(Plates 02-1,2)					
0203-15	527275		RETAINER W/GREASE SEAL, RELEASE SHAFT } INCL. GREASE.	10G, 12G, 14G	1
0203-15	529333		RETAINER W/GREASE SEAL, RELEASE SHAFT } FITTING	H, 3H, 4H	1
0203-16	723-03		GREASE FITTING (ALEMITE STRAIGHT).	10G, 12G, 14G, H, 3H, 4H	1
	1-0516		SCREW, TO CLUTCH HOUSING 5/16"-18X1"	10G, 12G, 14G, H, 3H, 4H	1
	380-05		WASHER, LOCK 5/16"	10G, 12G, 14G, H, 3H, 4H	1
0203-19	527277		GREASE SEAL, RELEASE SHAFT RETAINER (INCL. IN 527275)	10G, 12G, 14G	1
0203-19	527280		GREASE SEAL, RELEASE SHAFT RETAINER (INCL. IN 529333)	H, 3H, 4H	1
0203-28	532045		LEVER, OUTER, RELEASE SHAFT - LHC	14G	1
	533205		LEVER, OUTER, RELEASE SHAFT - RHC	14G	1
0203-28	532051		LEVER, OUTER, RELEASE SHAFT - LHC	4H	1
	533174		LEVER, OUTER, RELEASE SHAFT - RHC	4H	1
0203-30	522272		PIN, TO RELEASE SHAFT 1/4"X15/16"	14G	1
0203-30	438-0520		PIN, TO RELEASE SHAFT 5/16"X1 1/8"	4H	1
	----		COTTER 3/32"X1"	14G, 4H	1
0204- CLUTCH PEDAL AND SPRING (Plates 02-1,2)					
0204-1	530137		PEDAL, CLUTCH - LHC	10G, 12G, H, 3H	1
	530378		PEDAL, CLUTCH - RHC	10G, 12G, H, 3H	1
0204-1	532010		PEDAL, CLUTCH - LHC	14G, 4H	1
	533176		PEDAL, CLUTCH - RHC	14G, 4H	1
	12-0632		BOLT, CLAMP, TO SHAFT 3/8"-24X2"	10G, 12G, H, 3H	1
	12-0632		BOLT, CLAMP, TO SHAFT 3/8"-24X2" - LHC	14G, 4H	1
	252-06		NUT, HEX. 3/8"-24	10G, 12G, 14G, H, 3H, 4H	1
	----		WASHER, PLAIN 3/8"	10G, 12G, 14G, H, 3H, 4H	2
	380-06		WASHER, LOCK 3/8"	10G, 12G, 14G, H, 3H, 4H	1
0204-3	519432		SPRING, PEDAL PULLBACK - LHC	10G, 12G, H, 3H	1
	530381		SPRING, PEDAL PULLBACK - RHC	10G, 12G, H, 3H	1
0204-3	531049		SPRING, PEDAL PULLBACK	14G, 4H	1
	530380		EXTENSION, PEDAL PULLBACK SPRING TO PEDAL - RHC	10G, 12G, H, 3H	1
	533181		EXTENSION, PEDAL PULLBACK SPRING TO PEDAL - RHC	14G, 4H	1
0204-4	517504		STUD, PEDAL PULLBACK SPRING ANCHOR - LHC	10G, 12G, 14G, H, 3H, 4H	1
	251-05		NUT, HEX. 5/16"-18	10G, 12G, 14G, H, 3H, 4H	1
	361-05		WASHER, PLAIN 5/16"	14G, 4H	1
	380-05		WASHER, LOCK 5/16"	10G, 12G, 14G, H, 3H, 4H	1
0204-5	530561		PLATE, PEDAL TO STARTER, SWITCH CONTACT - (EXCEPT AD.)	10G, 12G, 14G, H, 3H, 4H	1
	----		WASHER, SPACING 1/2"	10G, 12G, 14G, H, 3H, 4H	1
1108-7	530366		GROMMET, PEDAL (ILLUST. PLATE 11-3.5)	10G, 12G, 14G, H, 3H, 4H	1
0204-8	675269		PAD, PEDAL	10G, 12G, 14G, H, 3H, 4H	1
	384-08		WASHER, SHAKEPROOF 1/2"	10G, 12G, 14G, H, 3H, 4H	1
1507-19	----		SHIELD, PEDAL SPLASH - SEE GROUPS 1507 AND 2138		
0205- CLUTCH PEDAL SHAFT (Plates 02-1,2)					
0205-1	529129		SHAFT AND LEVER, PEDAL - LHC	10G, 12G	1
	530382		SHAFT, PEDAL - RHC	10G, 12G, H, 3H	1
0205-1	529331		SHAFT AND LEVER, PEDAL - LHC	H, 3H	1
0205-1	533188		SHAFT, PEDAL - LHC	14G, 4H	1
	533180		SHAFT, PEDAL - RHC	14G, 4H	1
	256-10		NUT, SHAFT 5/8"-18 - RHC	14G, 4H	2
0205-3	532035		WASHER, SPACER, SHAFT - LHC	14G, 4H	1
	361-10		WASHER, PLAIN 5/8" - RHC	10G, 12G, 14G, H, 3H, 4H	1
	194823		RETAINER - RHC	10G, 12G, H, 3H	1

CLUTCH, PEDAL AND RELEASE MECHANISM

(Used With Standard And Overdrive Transmission)

0206

ILLUST. NUMBER	PART NUMBER	CHANGE	DESCRIPTION	MODELS	PER CAR
0205- CLUTCH PEDAL SHAFT-Cont'd. (Plates 02-1,2)					
		✓	GREASE FITTING, PEDAL SHAFT - RHC	14G, 4H.	1
	530383		LEVER, PEDAL SHAFT - RHC.	10G, 12G, H, 3H.	1
	12-0632		BOLT, CLAMP TO SHAFT 3/8"-24X1 7/8".	10G, 12G, H, 3H.	1
	252-06		NUT, HEX. 3/8"-24	10G, 12G, H, 3H.	1
			WASHER, PLAIN 3/8".	10G, 12G, H, 3H.	2
	380-06		WASHER, LOCK 3/8".	10G, 12G, H, 3H.	1
0205-8	194557		BUSHING, PEDAL SHAFT (LOCATED IN TUBE WELDED IN FRAME).	10G, 12G, 14G, H, 3H, 4H	1
0206- CLUTCH OPERATING SHAFT AND RODS (Plates 02-1,2)					
0206-1A	529178		SHAFT AND LEVER, OPERATING - LHC - NOTE 1 (ORDER 531489).	10G	1
0206-1A	531489		SHAFT AND LEVER, OPERATING - LHC - NOTE 2	10G, 12G	1
	530414		SHAFT AND LEVER, OPERATING - RHC - NOTE 1 (ORDER 531493).	10G	1
	531493		SHAFT AND LEVER, OPERATING - RHC - NOTE 2	10G, 12G	1
0206-1B	529467		SHAFT AND LEVER, OPERATING - LHC - NOTE 1	H	1
0206-1B	531488		SHAFT AND LEVER, OPERATING - LHC - NOTE 2	H, 3H.	1
	530389		SHAFT AND LEVER, OPERATING - RHC - NOTE 1	H	1
	531492		SHAFT AND LEVER, OPERATING - RHC - NOTE 2	H, 3H.	1
0206-1	532054		SHAFT AND LEVERS, OPERATING - LHC	14G, 4H.	1
	533215		SHAFT AND LEVERS, OPERATING - RHC	14G, 4H.	1
0206-8	532200		BEARING AND RETAINER KIT, OPERATING SHAFT	10G, 12G, 14G, H, 3H, 4H	1
	2-0512		BOLT, TO SUPPORT BRACKET 5/16"-24X3/4"	10G, 12G, 14G, H, 3H, 4H	2
	252-05		NUT, HEX. 5/16"-24	10G, 12G, 14G, H, 3H, 4H	2
	380-05		WASHER, LOCK 5/16".	10G, 12G, 14G, H, 3H, 4H	2

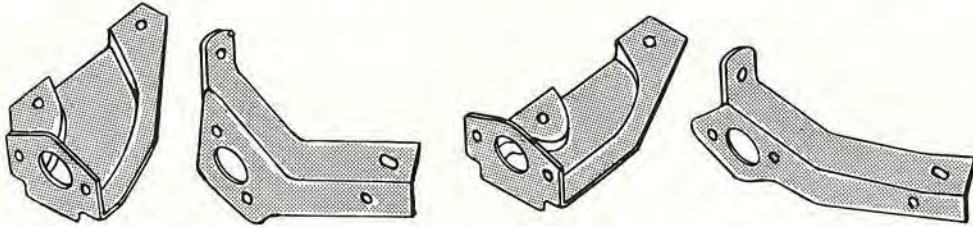

0206-19 A
0206-19 B
0206-19 C
0206-19 D

0206-19	529158		BRACKET, OPERATING SHAFT AND BEARING SUPPORT - LHC.	10G, 12G, H, 3H.	1
	530392		BRACKET, OPERATING SHAFT AND BEARING SUPPORT - RHC.	10G, 12G, H, 3H.	1
0206-19A	532053P		BRACKET, OPERATING SHAFT AND BEARING SUPPORT - W-F-D-N - LHC	14G	1
0206-19B	532123P		BRACKET, OPERATING SHAFT AND BEARING SUPPORT - C-K - LHC.	14G	1
	533170P		BRACKET, OPERATING SHAFT AND BEARING SUPPORT - RHC.	14G	1
0206-19C	532039P		BRACKET, OPERATING SHAFT AND BEARING SUPPORT-W-Y-F-D-N - LHC	4H.	1
0206-19D	532167P		BRACKET, OPERATING SHAFT AND BEARING SUPPORT - C-K - LHC.	4H.	1
	533167P		BRACKET, OPERATING SHAFT AND BEARING SUPPORT - RHC.	4H.	1
	1-0612		SCREW, TO TRANS. 3/8"-16X3/4" - W-Y-F-D-N - LHC.	14G, 4H.	2
	1-0612		SCREW, TO TRANS. 3/8"-16X3/4" - C-K - LHC.	14G, 4H.	1
			SCREW, CLUTCH HOUSING TO CYL. BLOCK - SEE GROUP 0209	14G, 4H.	1
			SCREW, TO TRANS. - RHC - SEE GROUP 0761.	14G, 4H.	2
	2-0612		BOLT, TO FRAME 3/8"-24X3/4" - LHC.	10G, 12G, H, 3H.	2
	252-06		NUT, HEX. 3/8"-24 - LHC.	10G, 12G, H, 3H.	2
			WASHER, PLAIN 3/8" - LHC.	10G, 12G, H, 3H.	2
	380-06		WASHER, LOCK 3/8" - LHC.	10G, 12G, H, 3H.	2
	380-06		WASHER, LOCK 3/8" - W-Y-F-D-N - LHC	14G, 4H.	2
	380-06		WASHER, LOCK 3/8" - C-K - LHC	14G, 4H.	1
	530393		BRACE, OPERATING SHAFT BRACKET AND BEARING SUPPORT - RHC.	10G, 12G, H, 3H.	1
	2-0612		BOLT, TO BRACKET 3/8"-24X3/4".	10G, 12G, H, 3H.	1
	252-06		NUT, HEX. 3/8"-24	10G, 12G, H, 3H.	1
			WASHER, PLAIN 3/8".	10G, 12G, H, 3H.	1
	380-06		WASHER, LOCK 3/8".	10G, 12G, H, 3H.	1

NOTES {

1 - USED ON MODELS	10G	H
BEFORE CAR SERIALS	SOUTH BEND G-1,083,741	8,175,910
	LOS ANGELES G-904,513	8,813,042

2 - USED ON AND AFTER CAR SERIALS IN NOTE 1.

CLUTCH, PEDAL AND RELEASE MECHANISM

(Used With Standard And Overdrive Transmission)

0206

ILLUST. NUMBER	PART NUMBER	CHANGE	DESCRIPTION	MODELS	PER CAR
0206- CLUTCH OPERATING SHAFT AND RODS-Cont'd.					
(Plates 02-1,2)					
0206-26	194643		SLEEVE, OPERATING SHAFT	10G, 12G	1
0206-26	199220		SLEEVE, OPERATING SHAFT	H, 3H	1
0206-26	199220		SLEEVE, OPERATING SHAFT - LHC	14G, 4H	1
	533179		SLEEVE, OPERATING SHAFT - RHC	14G, 4H	1
0206-27	522272		PIN, CLEVIS, TO RELEASE AND OPERATING SHAFTS	10G, 12G	2
0206-27	438-0520		PIN, CLEVIS, TO RELEASE AND OPERATING SHAFTS 5/16"X1 1/8"	H, 3H	2
0206-27	438-0520		PIN, CLEVIS, TO PEDAL AND OPERATING SHAFTS 5/16"X1 1/8" - LHC	14G, 4H	2
	----		PIN, CLEVIS, TO PEDAL SHAFT 5/16"X5/32" - RHC	14G, 4H	1
	438-0520		PIN, CLEVIS, TO OPERATING SHAFT 5/16"X1 1/8" - RHC	14G, 4H	1
	----		COTTER 3/32"X1"	10G, 12G, 14G, H, 3H, 4H	2
0206-28	533933		WASHER, SLEEVE TO OPERATING SHAFT ANTI-RATTLE - RUBBER.	14G, 4H	1
0206-29	527915		ROD, PEDAL SHAFT TO OPERATING SHAFT LEVER - LHC	10G, 12G, H, 3H	1
	530395		ROD, PEDAL SHAFT TO OPERATING SHAFT LEVER - RHC	10G, 12G, H, 3H	1
0206-29	532034		ROD, OPERATING SHAFT TO RELEASE SHAFT LEVER - W-Y-F-D-N	14G, 4H	1
0206-29	531992		ROD, OPERATING SHAFT TO RELEASE SHAFT LEVER - C-K	14G, 4H	1
0206-39	636805		CLEVIS, PEDAL SHAFT TO OPERATING SHAFT ROD ADJUSTING.	10G, 12G, H, 3H	1
0206-39	531993		CLEVIS, PEDAL SHAFT TO OPERATING SHAFT LEVER.	14G, 4H	1
0206-40	252-06		NUT, LOCK 3/8"-24.	10G, 12G, 14G, H, 3H, 4H	1
0206-43	438-0616		PIN, TO PEDAL AND OPERATING SHAFT LEVER 3/8"X27/32".	10G, 12G, 14G, H, 3H, 4H	2
0206-45	192057		WASHER, SPRING	10G, 12G, 14G, H, 3H, 4H	2
	----		COTTER 3/32"X1"	10G, 12G, 14G, H, 3H, 4H	2
0207- CLUTCH PILOT BEARING (Plates 01-4,6)					
0207-1	194348		BEARING, PILOT - COMPOSITION (LOCATED IN FLYWHEEL).	10G, 12G, 14G	1
0207-1	510168		BEARING, PILOT - COMPOSITION (LOCATED IN CRANKSHAFT).	H, 3H, 4H	1
0209- CLUTCH AND FLYWHEEL HOUSING (plates 01-3,5)					
0209-1	529322	◆	HOUSING W/BUSHING, CLUTCH	10G, 12G, 14G	1
0203-13	524848		PLUG, SHAFT HOLE - (CUPPED) 45/64" O.D. - LHC.	10G, 12G, 14G	1
0209-2	196420		DOWEL BOLT, TO ENGINE REAR PLATE (25/64" BODY) 3/8"-24X1	10G, 12G, 14G	2
	1-0620		SCREW, TO CYL. BLOCK 3/8"-16X1 1/4".	10G, 12G, 14G	3
	2-0516		BOLT, TO ENGINE REAR PLATE 5/16"-24X1"	10G, 12G, 14G	5
	252-05		NUT, HEX. 5/16"-24	10G, 12G, 14G	5
	252-06		NUT, HEX. 3/8"-24.	10G, 12G, 14G	2
	384-05		WASHER, LOCK 5/16".	10G, 12G, 14G	5
	384-06		WASHER, LOCK 3/8"	10G, 12G, 14G	5
0209-1	529324	◆	HOUSING W/BUSHING, CLUTCH	H, 3H, 4H	1
0203-13	524849		PLUG, SHAFT HOLE (CUPPED) 53/64" O.D. - LHC.	H, 3H, 4H	1
0209-3	531085		DOWEL, PIN, TO CYL. BLOCK 11/32"X1 1/8" - NOTE 3	H, 3H, 4H	2
0209-3	531086		DOWEL, PIN, TO CYL. BLOCK 3/8"X1 1/8" - NOTE 4	H, 3H, 4H	2
	1-0616		SCREW, TO CYL. BLOCK 3/8"-16X1".	H, 3H, 4H	7
	380-06		WASHER, LOCK 3/8"	H, 3H, 4H	7
		◆	WHEN USED ON RHC CARS, REMOVE SHAFT HOLE PLUG.		
0209-5	531319		PLATE, HOUSING COVER FRONT (ILLUST. PLATE 01-5)	H, 3H, 4H	1
	2-0516		BOLT, TO HOUSING 5/16"-24X1"	H, 3H, 4H	4
	252-05		NUT, HEX. 5/16"-24	H, 3H, 4H	4
	361-05		WASHER, PLAIN 5/16".	H, 3H, 4H	2
	380-05		WASHER, LOCK 5/16".	H, 3H, 4H	4
0209-6	527420		BUSHING, HOUSING.	10G, 12G, 14G	1
0209-6	527421		BUSHING, HOUSING.	H, 3H, 4H	1

NOTES { 3 - FOR REGULAR PRODUCTION, USED WHEN RE-ALIGNMENT OF HOUSING NOT REQUIRED.
 4 - MUST BE USED WHEN REPLACING HOUSING OR INSTALLING A STRIPPED ENGINE.

TORQUE CONVERTER

(Used With Automatic Transmission)

0230

ILLUST. NUMBER	PART NUMBER	CHANGE	DESCRIPTION	MODELS	PER CAR
----------------	-------------	--------	-------------	--------	---------

0220- TORQUE CONVERTER

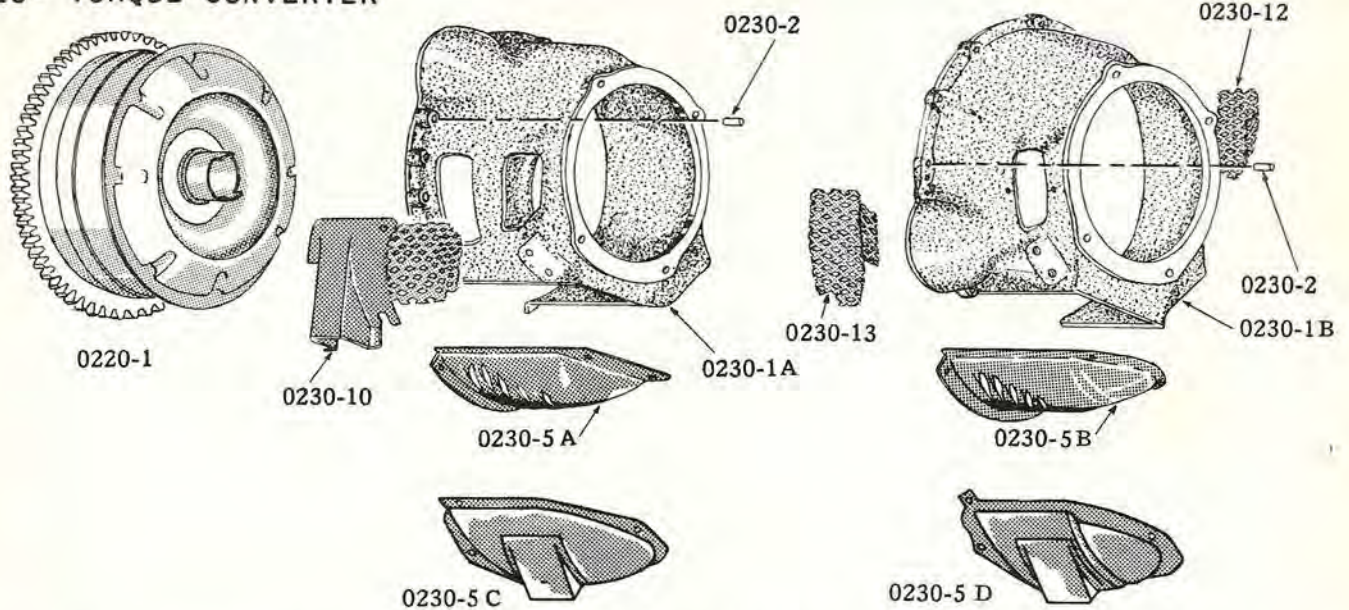

0220-1	527825		CONVERTER COMPLETE, TORQUE (INCL. STARTER GEAR)	10G, 12G, 14G	1
0220-1	530331		CONVERTER COMPLETE, TORQUE (INCL. STARTER GEAR)	H, 3H, 4H	1
	264-06		NUT, TO PLATE 3/8"-24.	10G, 12G, 14G, H, 3H, 4H	6
	----		WASHER, PLAIN 3/8"	10G, 12G, 14G, H, 3H, 4H	6
	529075		PLUG, DRAIN 3/8"-24 SPECIAL.	10G, 12G, 14G, H, 3H, 4H	1
	529076		GASKET, PLUG 15/64" - COPPER.	10G, 12G, 14G, H, 3H, 4H	1
0207-1	510168		BEARING, TORQUE CONVERTER PILOT - COMPOSITION (LOCATED IN CRANKSHAFT) (ILLUST. PLATE O1-6)	H, 3H, 4H	1

0230- TORQUE CONVERTER HOUSING (Illustr. Group 0220)

0230-1A	527552		HOUSING, TORQUE CONVERTER	10G, 12G, 14G	1
0230-1B	530270		HOUSING, TORQUE CONVERTER	H, 3H, 4H	1
0230-3	531085		DOWEL, PIN, TO ENGINE PLATE 11/32"X1 1/8" - NOTE 3	10G, 12G, 14G, H, 3H, 4H	2
0230-3	531086		DOWEL, PIN, TO ENGINE PLATE 3/8"X1 1/8" - NOTE 4	10G, 12G, 14G, H, 3H, 4H	2
	1-0622		SCREW, TO CYLINDER BLOCK 3/8"-16X1 1/2".	10G, 12G, 14G	3
	1-0616		SCREW, ENGINE PLATE TO HOUSING 3/8"-16X1".	10G, 12G, 14G	5
	1-0616		SCREW, TO CYLINDER BLOCK 3/8"-16X1".	H, 3H, 4H	7
	380-06		WASHER, LOCK 3/8"	10G, 12G, 14G, H, 3H, 4H	*
0230-5A	527683		COVER, CONVERTER HOUSING.	10G, 12G	1
0230-5C	532882		COVER, CONVERTER HOUSING.	14G	1
0230-5B	530401		COVER, CONVERTER HOUSING.	H, 3H.	1
0230-5D	532522		COVER, CONVERTER HOUSING.	4H.	1
	1-048		SCREW, TO HOUSING 1/4"-20X1/2".	10G, 12G, 14G, H, 3H, 4H	4
	2-0512		BOLT, TO FRONT PLATE 5/16"-24X3/4".	H, 3H, 4H	2
	252-05		NUT, HEX. 5/16"-24.	H, 3H, 4H	2
	361-05		WASHER, PLAIN 5/16"	H, 3H, 4H	1
	----		WASHER, LOCK 1/4"	10G, 12G, 14G, H, 3H, 4H	4
	380-05		WASHER, LOCK 5/16"	10G, 12G, 14G, H, 3H, 4H	2
0230-10	530169		AIR INTAKE AND SCREEN, CONVERTER HOUSING.	10G, 12G, 14G	1
	1-048		SCREW, TO HOUSING 1/4"-20X1/2".	10G, 12G, 14G	2
	----		WASHER, PLAIN 1/4".	10G, 12G, 14G	2
	----		WASHER, LOCK 1/4".	10G, 12G, 14G	2

NOTES { * - USE AS REQUIRED.
 3 - FOR REGULAR PRODUCTION, USED WHEN RE-ALIGNMENT OF HOUSING NOT REQUIRED.
 4 - MUST BE USED WHEN REPLACING HOUSING OR INSTALLING A STRIPPED ENGINE.

TORQUE CONVERTER

(Used With Automatic Transmission)

0230

ILLUST. NUMBER	PART NUMBER	CHANGE <input checked="" type="checkbox"/>	DESCRIPTION	MODELS	PER CAR
0230- TORQUE CONVERTER HOUSING-Cont'd.					
(Illustr. Group 0220)					
0230-12	530342P		SCREEN, RIGHT, CONVERTER HOUSING.	H.3H.4H	1
0230-13	530343P		SCREEN, LEFT, CONVERTER HOUSING	H.3H.4H	1
	1-048		SCREW, TO HOUSING 1/4"-20X1/2"	H.3H.4H	4
	----		WASHER, PLAIN 1/4"	H.3H.4H	4
	----		WASHER, LOCK 1/4"	H.3H.4H	4
0209-5	531319		PLATE, CONVERTER HOUSING COVER FRONT (ILLUST. PLATE 01-5) .	H.3H.4H	1
	2-0516		BOLT, TO HOUSING 5/16"-24X1"	H.3H.4H	2
	252-05		NUT, HEX. 5/16"-24.	H.3H.4H	2
	361-05		WASHER, PLAIN 5/16"	H.3H.4H	1
	380-05		WASHER, LOCK 5/16"	H.3H.4H	2